

SPECIFICATIONS

STRUCTURAL SPECIFICATIONS

1. CONCRETE
 - a. Concrete materials shall comply with ASTM C150.
 - b. Concrete for flat work shall achieve a minimum strength of 3,500 PSI at 28 days.
 - c. Maximum slump of 4 inches.
 - d. Concrete exposed to the weather shall be air entrained a minimum of 5% but no more than 7% by volume.
 - e. Concrete flat work shall receive a broom finish.
 - f. Welded -wire-mesh shall be unfinished, ASTM A185.
2. WOOD FRAMING
 - a. Dimensional wood framing shall be No. 2 or better Canadian SPF, Canadian or U.S. D.Fir-L, Hem-Fir, or S. Pine.
 - b. LVL = laminated veneer lumber, E=1,900,000 psi minimum.
 - c. LSL = laminated strand lumber, E=1,300,000 psi minimum.
 - d. Plywood shall be CDX grade.
 - e. Lumber in direct contact with masonry or concrete shall be pressure preservative treated.

DOOR AND HARDWARE SPECIFICATIONS

- DOORS**
1. HOLLOW METAL DOORS
 - a. 1-3/4" thick.
 - b. 18 gauge steel, welded edges, primed.
 - c. Glazing shall be tempered insulating glass.
 - d. doors shall be insulated with polystyrene or polyurethane.
 2. HOLLOW METAL FRAMES
 - a. 16 gauge KD style in sizes required for wall thicknesses.
 3. UPWARD ACTING GARAGE DOORS
 - a.
- HARDWARE**
4. HINGES
 - a. Provide (3) stainless steel hinges
 5. FIRE EXIT BOLT
 - a. Deadlocking latch bolt type fire exit bolt conforming to ANSI A156.3, Grade 1, Dorma 8000 series or equal.
 - b. Panic bar operation from push side and keyed entry from pull side.
 6. KEYING
 - a. Key to match existing doors.
 7. CLOSERS
 - a. Closers shall be ANSI A156.4, grade 1, surface mounted, Dorma 8600 series, or equal.
 - b. Arms shall be parallel arm type. Mount closers on push side of door unless noted otherwise.
 8. KICK PLATES
 - a. Hager 198S - .038" thick, or equal;
 - b. 8" X 4" shorter than door width, or equal.
 9. PULL PLATE
 - a. Hager 31E, US32D finish, or equal.
 - b. 3" X 12".
 10. THRESHOLDS (Exterior)

Thresholds shall be aluminum and no more than 1/2" in height for accessibility, NGP 513 or equal.
 11. WEATHERSTRIPPING
 - a. Jamb and head seals shall be a vinyl, or silicone rubber bulb seal held in place with an aluminum extrusion, NGP 160 V, or equal.
 - b. Door bottom seals shall be a neoprene or vinyl sweep held in place with an aluminum extrusion, NGP 98V or equal.
 12. HARDWARE FINISH

Hardware finish shall be US32D, satin stainless steel.

SECTIONAL OVERHEAD DOORS

- A. Insulated Steel Sectional Overhead Doors: 432 Series Insulated Steel Doors by Overhead Door Corporation, or equal. Units shall have the following characteristics:
 1. Door Assembly: Insulated steel door assembly with rabbeted meeting rails to form weathertight joints and provide full-width interlocking structural rigidity.
 - a. Panel Thickness: 2 inches (51 mm).
 - b. Exterior Surface: Ribbed.
 - c. Exterior Steel: Nominal 24 gauge, hot -dip galvanized.
 - d. Back Cover:
 - 1) 26 gauge steel.
 - e. Center and End Stiles: 16 gauge steel.
 - f. Springs:
 - 1) 10,000 cycles.
 - g. Insulation: Polystyrene, R-7.35
 - h. Full Glazed Aluminum Sash Panels:
 - 1) Insulated double strength glass.
 2. Finish and Color: Two coat baked-on polyester with white exterior and white interior color.
 3. Hardware: Galvanized steel hinges and fixtures. Ball bearing rollers with hardened steel races.
 4. Lock: Keyed lock with interlock switch for automatic operator.
 5. Weatherstripping:
 - a. Flexible bulb-type strip at bottom section.
 - b. Flexible Jamb seals.
 - c. Flexible Header seal.
 6. Electric Motor Operation:
 - a. Provide UL listed electric operator, size and type as recommended by manufacturer to move door in either direction at not less than 2/3 foot nor more than 1 foot per second. Operator shall meet UL325/2010 requirements for continuous monitoring of safety devices.

EXTERIOR SPECIFICATIONS

- SIDING**
1. Prefinished metal siding to match existing.
- PAINTING**
2. Exterior: If siding color does not match, paint with (2) coats exterior latex to match existing color.
 3. Door and frame: (2) coats alkyd enamel.
 4. Exterior wood: (1) coat latex primer plus (2) coats latex semigloss.
 5. Interior Drywall: (1) coat latex primer plus (2) coats latex eggshell.

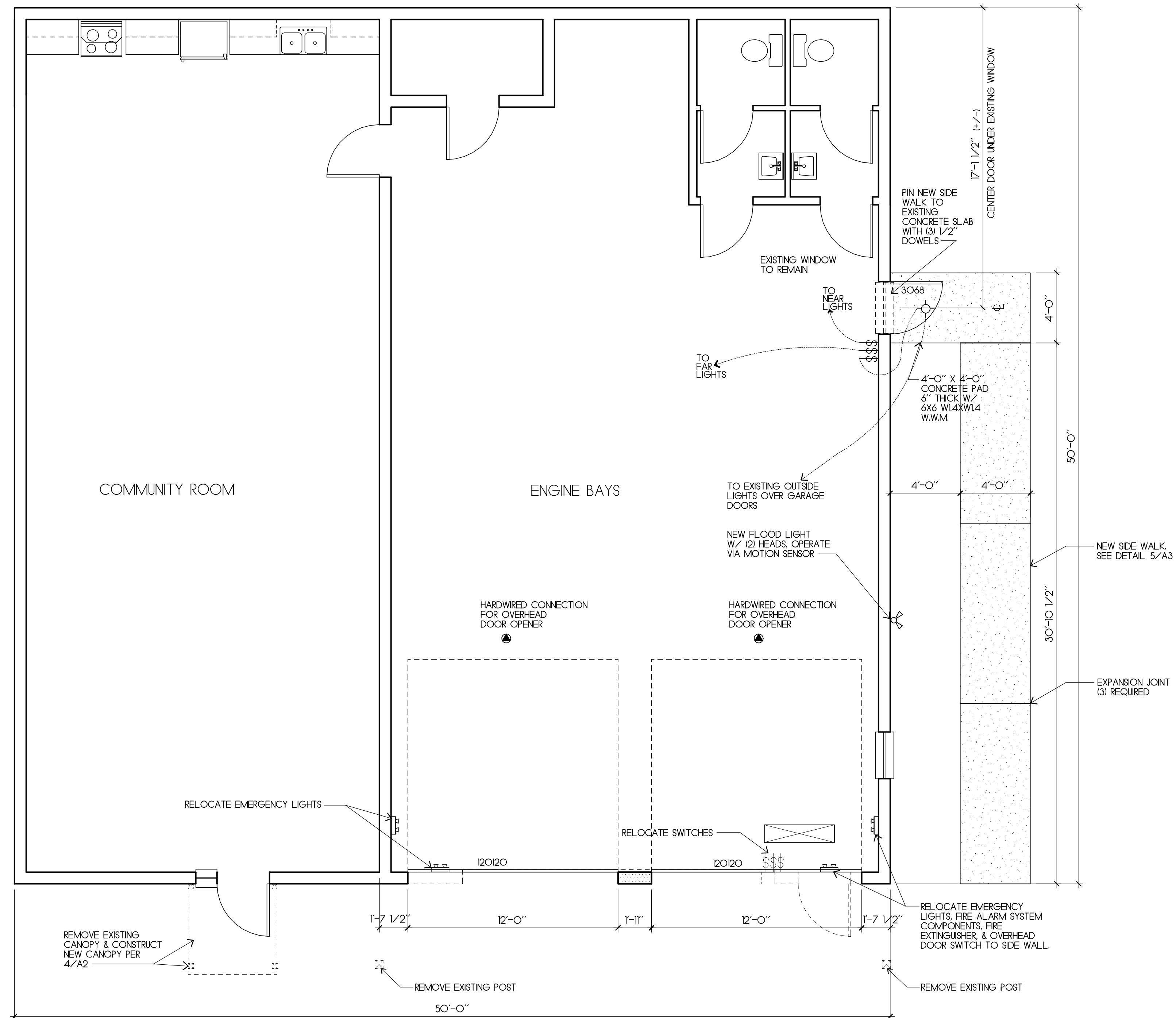

2 FLOOR PLAN
1/4" = 1'-0"

WALL LEGEND	
	DEMO EXISTING WALL
	NEW WALL
	EXISTING WALLS TO REMAIN

SEAL

Beckwith Group
ARCHITECTS

1380 Route 44, Suite B-69
P.O. Box 66
Tel: 845.635.9315 fax: 845.635.9430
email: beckwitharchitect@gmail.com
www.beckwitharchitect.com

NEW DOORS FOR THE STORMVILLE FIRE COMPANY SUBSTATION EAST FISHKILL FIRE DEPARTMENT
26 MOUNTAIN TOP ROAD, STORMVILLE, NY 12562

SCALE	As Noted
DATE	09-23-16
DRAWN BY	DAB/RAM

DATE	REVISION
10/24/16	CLIENT REVIEW/REVISIONS
11/08/16	REBUILD COMMUNITY ROOM ENTRY CANOPY
12/10/16	PN SIDE WALK TO EXISTING SLAB

DRAWING TITLE
PLANS & SPECIFICATIONS

DRAWING NUMBER
A1

Job Number: 16032